

# Plat of Survey

A PROPERTY BOUNDARY SURVEY  
AND MINOR SUBDIVISION OF LAND FOR  
RAYMOND M. AND ADA MILLER  
VOL. 770 PG. 417, P.P. NO. 32-047-700

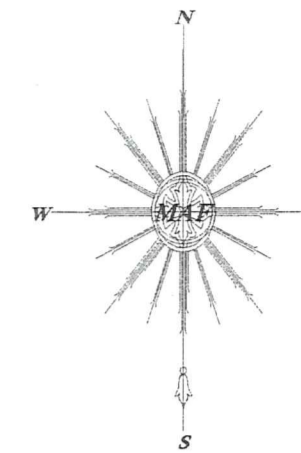

BEARINGS ARE ASSUMED AND ARE INTENDED TO DENOTE THE RELATIONSHIP BETWEEN ANGLES ONLY.

SURVEY PLAT & LEGAL DESCRIPTION  
APPROVED PER R.C. 315.251

*R.S.* 11/8/2000

OFFICE OF THE  
GEAUGA COUNTY ENGINEER

AARON M. AND MALINDA C. MILLER  
VOL. 1301 PG. 999

5/8" IRON PIN FD.,  
IN MON. BOX,  
REC'D STA. 238+00

ABNER R. & ELLEN S. MILLER  
VOL. 784 PG. 273

5/8" IRON PIN FD.,  
AT 29.90' W/ KOSIE CAP

5/8" IRON PIN FD.,  
W/ KOSIE CAP

S 89°30'00" E - 755.48' MEAS'D.

RAYMOND M. AND ADA MILLER  
ORIGINALLY BEING A PART OF VOL. 770 PG. 417  
PARCEL NO. 2

12.3665 ACRES  
VACANT LAND

NOTE: WOODEN FENCE SURROUNDS CEMETARY

N 89°52'00" W  
160.69'  
22 AC. DEED

AMISH  
CEMETARY  
.5 AC. DEED

CEMETARY - TRUSTEES OF TROY AMISH  
VOL. 152 PG. 494  
TRUSTEES OF TROY TWP.  
VOL. 119 PG. 628

NOTE: THE WIRE FENCE LINE EAST AND  
CEMETARY FENCE LINE ARE @ 2' SOUTH  
OF THE WEST FENCE LINE AND PROPERTY LINE.  
THE CEMETARY FENCE IS 25' OFF CENTERLINE.  
AN ANGLE POINT NEAR THE CENTERLINE  
IN THE SECTION LINE IS APPARENT.

MONROE R. AND KATIE M. SCHMUCKER  
VOL. 671 PG. 326

I CERTIFY THAT THIS PLAT REPRESENTS A FIELD SURVEY  
AND IS BASED UPON FIELD MEASUREMENTS  
MADE UNDER MY SUPERVISION AND ON THE EVIDENCE  
FOUND. DISTANCES ARE EXPRESSED IN FEET AND DECIMAL  
PARTS THEREOF, IN ACCORDANCE WITH OHIO ADMINISTRATIVE CODE  
4733-37. MONUMENTS WERE FOUND OR SET AS INDICATED.

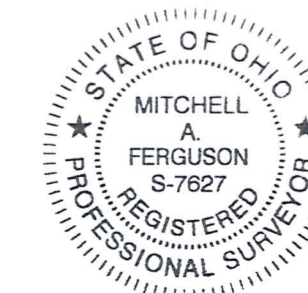

**M.A. Ferguson Land Surveying**

PO Box 163  
Madison, Ohio 44057  
440-428-9563

Job. No. 10-051-00  
Jug Street  
Section 10  
Troy Twp., Geauga Co.

Attest: *Mitchell A. Ferguson* Date: **NOVEMBER 7, 2000**

Mitchell A. Ferguson  
Professional Land Surveyor  
Registration No. 7627

SITUATE IN THE TOWNSHIP OF TROY, COUNTY OF GEAUGA,  
AND THE STATE OF OHIO, AND KNOWN AS BEING A PART OF SECTION 10  
TWP 6N, RANGE VII W, OF THE CONNECTICUT WESTERN RESERVE.

● 5/8" x 30" IRON PIN SET W/ "FERGUSON" CAP

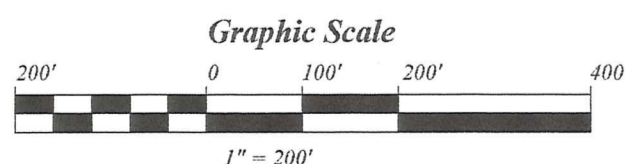

CHALLIS WOOD, TRUSTEE  
VOL. 1307 PG. 961

EMIL AND VERNA E. MACEK  
VOL. 667 PG. 0331

1" IRON PIPE FD.,  
@ 1.32' EASTERLY

1" IRON PIPE FD.,  
@ 22' OFF CL.

ELAINE CHITTLE &  
MARTHA MATTSON  
VOL. 807 PG. 529

PARCEL NO. 3  
6.0105 ACRES  
LOT SPLIT 32-072353

S 89°33'00" E - 800.00'

RAYMOND M. AND ADA MILLER  
VOL. 770 PG. 417

PARCEL NO. 1  
94.8146 ACRES

32-047700

MONROE R. AND KATIE M. SCHMUCKER  
VOL. 671 PG. 326

LAUREN R. AND WANDA E. WILLIAMS  
VOL. 733 PG. 702 &  
VOL. 670 PG. 1206

DAVID R. AND EMMA J. MILLER  
VOL. 1301 PG. 982

ROBERT C. AND ANNA K. SLABAUGH  
VOL. 867 PG. 960

HOWARD E. &  
SANDRA L. BUCKLES  
VOL. 1173 PG. 106

SECTION 11

SECTION 10

SECTION 12

SECTION 9

SECTION 10

SECTION 9

JUG STREET - 60'

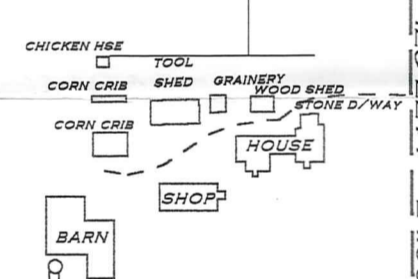

1" IRON PIN FD.  
INSIDE MONUMENT BOX  
AT PATCH ROAD AND JUG ST.

DAVID J. BYLER &  
JILL J. FUCKETT  
VOL. 909 PG. 978

JAMES ALLEN & SANDRA BURZANKO  
VOL. 509 PG. 805

N 1°14'50" W - 1842.87'

5/8" IRON PIN FD.

3.5" IRON POST FD.  
1" NORTH OF LINE

5/8" IRON PIN FD.,  
W/ FERGUSON CAP

5/8" IRON PIN FD.,  
W/ FERGUSON CAP

N 89°57'30" W - 2646.00'  
1817.18' - CALCULATED

FENCE LINE - ON OR NEAR PROPERTY LINE

5/8" IRON PIN FD.  
W/ SCHWARTZ CAP

5/8" IRON PIN FD.  
W/ SCHWARTZ CAP

S 0°10'50" E  
262.63'

1.5" IRON PIPE FD.,  
1' NORTH OF CORNER

S 89°33'00" E - 873.65'

S 0°31'0" E 387.00'

S 89°33'00" E - 451.50'

S 0°31'0" E  
137.00'

S 89°33'00" E  
348.50'

137.00'

250.00'

JUG STREET - 60'

S 89°37'15" E  
169.86'

5/8" IRON PIN FD.,

3.5" IRON POST,  
FD. & USED

N 0°30'00" W  
299.53'

S 89°37'15" E  
169.86'

5/8" IRON PIN FD.,

3.5" IRON POST,  
FD. & USED

N 0°30'00" W  
299.53'

S 89°37'15" E  
169.86'

5/8" IRON PIN FD.,

3.5" IRON POST,  
FD. & USED

N 0°30'00" W  
299.53'

S 89°37'15" E  
169.86'

5/8" IRON PIN FD.,

3.5" IRON POST,  
FD. & USED

N 0°30'00" W  
299.53'

S 89°37'15" E  
169.86'

5/8" IRON PIN FD.,

3.5" IRON POST,  
FD. & USED

N 0°30'00" W  
299.53'

S 89°37'15" E  
169.86'

5/8" IRON PIN FD.,

3.5" IRON POST,  
FD. & USED

N 0°30'00" W  
299.53'

S 89°37'15" E  
169.86'

5/8" IRON PIN FD.,

3.5" IRON POST,  
FD. & USED

N 0°30'00" W  
299.53'

S 89°37'15" E  
169.86'

5/8" IRON PIN FD.,

3.5" IRON POST,  
FD. & USED

N 0°30'00" W  
299.53'

S 89°37'15" E  
169.86'

5/8" IRON PIN FD.,

3.5" IRON POST,  
FD. & USED

N 0°30'00" W  
299.53'

S 89°37'15" E  
169.86'

5/8" IRON PIN FD.,

3.5" IRON POST,  
FD. & USED

N 0°30'00" W  
299.53'

S 89°37'15" E  
169.86'

5/8" IRON PIN FD.,

3.5" IRON POST,  
FD. & USED

N 0°30'00" W  
299.53'

S 89°37'15" E  
169.86'

5/8" IRON PIN FD.,

3.5" IRON POST,  
FD. & USED

N 0°30'00" W  
299.53'

S 89°37'15" E  
169.86'

5/8" IRON PIN FD.,

3.5" IRON POST,  
FD. & USED

N 0°30'00" W  
299.53'

S 89°37'15" E  
169.86'

5/8" IRON PIN FD.,

3.5" IRON POST,  
FD. & USED

N 0°30'00" W  
299.53'

S 89°37'15" E  
169.86'

5/8" IRON PIN FD.,

TRO 00081

TRO-00081  
**MAF Surveying**

Raymond Miller -  
Picked up 11-16-2000  
32-047700

Vol. 1328-Pg. 562

Mitchell A. Ferguson  
Registered Professional Land Surveyor

P.O. Box 163  
Madison, Ohio 44057  
440-428-9563

**Survey Description of Property  
for  
Raymond M. and Ada Miller  
Parcel No. 1**

Situate in the Township of Troy, County of Geauga, and the State of Ohio, and known as being a part of Section 10, TWP. 6N, Range VIIW, of the Connecticut Western Reserve, further bounded and described as follows:

Beginning at an 1" iron pin found inside a monument box at the intersection of Patch Road and Jug Street, both 60 feet in width, thence **North 0°31'00" West**, along the centerline of Jug Street, a distance of **937.06 feet** to a point on southerly line of Section 10 and the northerly line of lands conveyed to Monroe R. and Katie M. Schmucker, as recorded in Vol. 671, Pg. 326 of the Geauga County Record of Deeds, and **The Principle Point of Beginning:**

**Course No. 1:** Thence **North 89°57'30" West**, along the section line and the northerly line of said Schmucker lands, passing through a 5/8 inch iron pin set at **30.00 feet** off the centerline, and passing through a 5/8 inch iron pin found with "Ferguson" cap at a distance of 1817.18 feet at the northeasterly corner of lands conveyed to David R. and Emma J. Miller, as recorded in Vol. 1301 Pg. 982, of the Geauga county Official Records, and passing through a 5/8 inch iron pin found at a distance of 2019.76 feet at the northeasterly corner of lands conveyed to Lauren R. and Wanda E. Williams, as recorded in Vol. 670 Pg. 1206, and continuing along the North line of said Williams and the North line of a second parcel for said Williams as recorded in Vol. 733, Pg. 702 of the Geauga County Record of Deeds, a total distance of **2646.00 feet** to a 5/8 iron pin found at the southwesterly corner of Section 10 and the easterly line of lands conveyed to Howard E. and Sandra L. Buckles, as recorded in Vol. 1173 Pg. 106 of the Geauga County Official Records;

**Course No. 2:** Thence **North 1°14'50" West**, along the westerly line of section 10 and the easterly line of said Buckles lands, and the easterly line of lands conveyed to James Allen and Sandra Burzanko, as recorded in Vol. 509 Pg. 805, of the Geauga County Record of Deeds, and the easterly line of lands conveyed to David J. Byler and Jill J. Puckett, as recorded in Vol. 909 Pg. 978 of the Geauga County Official Records; a total distance of **1842.87 feet** to a 5/8 inch iron pin found with "Schwartz" cap on the southwesterly corner of lands conveyed to Challis Wood, Trustee, as recorded in Vol. 1307 Pg. 961 of the Geauga County Official Records;

**Course No. 3:** Thence **South 89°45'25" East**, along said line of Wood, Trustee, a total distance of **997.58 feet** to a 5/8 inch iron pin found with "Schwartz" cap on the westerly line of lands conveyed to Emil and Vera E. Macek, as recorded in Vol. 667 Pg. 0331 of the Geauga County Record of Deeds;

**Parcel No. 1 continued**

**Course No. 4:** Thence **South 0°10'50" East**, along the westerly line of said Macek lands, passing through a 1.5 inch iron pipe found at a distance of 261.68 feet, a total distance of **262.68 feet** to a 3.5 inch iron post found on the southwesterly corner of said Macek lands;

**Course No. 5:** Thence **South 89°33'00" East**, along the southerly line of said Macek lands, a distance of **873.65 feet** to a 5/8 inch iron pin set an angle point;

**Course No. 6:** Thence **South 0°31'00" East**, a distance of **387.00 feet** to a 5/8 inch iron pin set an angle point;

**Course No. 7:** Thence **South 89°33'00" East**, passing through a 5/8 inch iron pin set at a distance of 770.00 feet, a total distance of **800.00 feet** to the centerline of said Jug Street;

**Course No. 8:** Thence **South 0°31'00" East**, passing through an 1 inch iron pin found at a distance of 435.38 feet inside a monument box at record Sta. 238+00, a total distance of **1177.37 feet** to **The Principle Point of Beginning**, containing **94.8146 acres** of land, of which **0.8109 acre** is within the right of way and subject to all legal highways and easements.

Surveyed and Described by Mitchell A. Ferguson, Professional Land Surveyor No.7627, in October, 2000 and intending to describe a parcel of land being subdivided from **Vol. 770, Pg. 417**. The bearings are assumed and are intended to denote the relationship between angles only.

**Note: All iron pins set on property described are 5/8" x 30" iron pins w/ surveyor's I.D. cap, "Ferguson - 7627".**

SURVEY PLAT & LEGAL DESCRIPTION  
APPROVED PER R.C. 315.251

*R.S.* \_\_\_\_\_ *11/18/2000*

OFFICE OF THE  
GEAUGA COUNTY ENGINEER

**MAF Surveying**

Mitchell A. Ferguson  
Registered Professional Land Surveyor

P.O. Box 163  
Madison, Ohio 44057  
440-428-9563

**Survey Description of Property  
for  
Raymond M. and Ada Miller  
Parcel No. 2**

Situate in the Township of Troy, County of Geauga, and the State of Ohio, and known as being a part of Section 10, TWP. 6N, Range VIIW, of the Connecticut Western Reserve, further bounded and described as follows:

Beginning at an 1" iron pin found inside a monument box located in the centerline of Jug Street, 60' in width, at record Sta. 238+00, thence **South 0°31'00" East**, along the centerline of Jug Street, a distance of **176.97 feet** to the southwesterly corner of lands conveyed to Abner R. and Ellen S. Miller, as recorded in Vol. 784 Pg. 273 of the Geauga County Official Records and **The Principle Point of Beginning:**

**Course No. 1:** Thence **South 89°30'00" East**, passing through a 5/8 inch iron pin found with "Kosie" cap at **29.90 feet** off the centerline, a total distance of **755.48 feet** to a 5/8 iron pin found with "Kosie" cap at the southeasterly corner of said Miller lands;

**Course No. 2:** Thence **North 0°30'00" West**, along the easterly line of said Miller lands, a distance of **299.53 feet** to a 5/8 inch iron pin found on the southerly line of lands conveyed to Aaron M. and Malinda C. Miller, as recorded in Vol. 1301 Pg. 999 of the Geauga County Official Records;

**Course No. 3:** Thence **South 89°37'15" East**, along said line of Miller lands, a distance of **169.86 feet** to a 3.5 inch iron post found, at the southeasterly corner of said Aaron M. and Malinda C. Miller lands, and the westerly line of lands conveyed to Robert C. and Anna K. Slabaugh, as recorded in Vol. 867 Pg. 960 of the Geauga County Official Records;

**Course No. 4:** Thence **South 0°10'30" West**, along the westerly line of said Slabaugh lands, a distance of **861.75 feet** to a 5/8 inch iron pin set on the northerly line of lands conveyed to Monroe R. and Katie M. Schmucker, as recorded in Vol. 671 Pg. 326 of the Geauga County Record of Deeds;

**Course No. 5:** Thence **North 89°52'00" West**, along the northerly line of said Schmucker lands, a distance of **754.25 feet** to a 5/8 inch iron pin set on the southeasterly corner of lands conveyed to the Trustees of Troy Township, as recorded in Vol. 119 Pg. 628 of the Geauga County Record of Deeds;

**Course No. 6:** Thence **North 0°31'00" West**, along the easterly line of said Troy Township lands, and the easterly line of lands conveyed to the Trustees of Troy Amish, as recorded in Vol. 152 Pg. 494 of the Geauga County Record of Deeds, a distance of **189.32 feet** to a 5/8 inch iron pin set on the northeasterly corner of said Troy Amish lands;

**Parcel No. 2 continued**

**Course No. 7:** Thence **North 89°52'00" West**, along the northerly line of said Amish Trustees lands, passing through a 5/8 inch iron pin set on the easterly right of way at a distance of 130.69 feet, a total distance of **160.69 feet** to the northwesterly corner of said Amish Trustees land and the centerline of said Jug Street;

**Course No. 8:** Thence **North 0°31'00" West**, along the said centerline, a distance of **378.50 feet** to **The Principle Point of Beginning**, containing **12.3665 acres** of land, of which **0.2606 acre** is within the right of way and subject to all legal highways and easements.

Surveyed and Described by Mitchell A. Ferguson, Professional Land Surveyor No.7627, in October, 2000 and intending to describe a parcel of land being subdivided from **Vol. 770, Pg. 417**. The bearings are assumed and are intended to denote the relationship between angles only.

**Note:** All iron pins set on property described are 5/8" x 30" iron pins w/ surveyor's I.D. cap, "Ferguson - 7627".

SURVEY PLAT & LEGAL DESCRIPTION  
APPROVED PER R.C. 315.251

R.S. 11/8/2000

OFFICE OF THE  
GEAUGA COUNTY ENGINEER

**MAF Surveying**

Mitchell A. Ferguson  
Registered Professional Land Surveyor

P.O. Box 163  
Madison, Ohio 44057  
440-428-9563

**Survey Description of Property  
for  
Raymond M. and Ada Miller  
Parcel No. 3**

Situate in the Township of Troy, County of Geauga, and the State of Ohio, and known as being a part of Section 10, TWP. 6N, Range VIIW, of the Connecticut Western Reserve, further bounded and described as follows:

Beginning at an 1" iron pin found inside a monument box located in the centerline of Jug Street, 60' in width, at record Sta. 238+00, thence **North 0°31'00" West**, along the centerline of Jug Street, a distance of **435.38 feet** to **The Principle Point of Beginning**:

**Course No. 1:** Thence **North 89°33'00" West**, passing through a 5/8 inch iron pin set at **30.00 feet** off the centerline, a total distance of **800.00 feet** to a 5/8 iron pin set at an angle point;

**Course No. 2:** Thence **North 0°31'00" West**, a distance of **387.00 feet** to a 5/8 inch iron pin set on the southerly line of lands conveyed to Emil and Verna E. Macek, as recorded in Vol. 667 Pg. 0331 of the Geauga County Record of Deeds;

**Course No. 3:** Thence **South 89°33'00" East**, along said line of Macek lands, a distance of **451.50 feet** to a point at the northwesterly corner of lands conveyed to Elaine Chittle and Martha Mattson, as recorded in Vol. 807 Pg. 529 of the Geauga County Record of Deeds, said point witnessed by a 1 inch iron pipe found 1.32 feet easterly;

**Course No. 4:** Thence **South 0°31'00" East**, along the westerly line of said Chittle and Mattson lands, a record distance of **137.00 feet** to a 5/8 inch iron pin set at the southwest corner of said Chittle and Mattson lands;

**Course No. 5:** Thence **South 89°33'00" East**, along the southerly line of said Chittle and Mattson lands, passing through a 5/8 inch iron pin set at a distance of 318.50 feet, a total distance of **348.50 feet** to the southeasterly corner of said Chittle and Mattson lands and the centerline of said Jug Street;

**Course No. 6:** Thence **South 0°31'00" East**, along the said centerline, a distance of **250.00 feet** to **The Principle Point of Beginning**, containing **6.0105 acres** of land, of which **0.1722 acre** is within the right of way and subject to all legal highways and easements.

Surveyed and Described by Mitchell A. Ferguson, Professional Land Surveyor No.7627, in October, 2000 and intending to describe a parcel of land being subdivided from **Vol. 770, Pg. 417**. The bearings are assumed and are intended to denote the relationship between angles only.

**Note:** All iron pins set on property described are 5/8" x 30" iron pins w/ surveyor's I.D. cap, "Ferguson - 7627".

SURVEY PLAT & LEGAL DESCRIPTION  
APPROVED PER R.C. 315.251

*R.S.* 11/8/2000

OFFICE OF THE  
GEAUGA COUNTY ENGINEER